

P/N:MPP 684J450V P=15

DRAWING & MARKING		Protection/Coating 外封装	Flame retardant epoxy resin (UL94V-0)
		Resin filled 灌封	
		Lead Wire 导线	Φ 0.6 tinned steel copper wires
DAIN		Colour 颜色	red

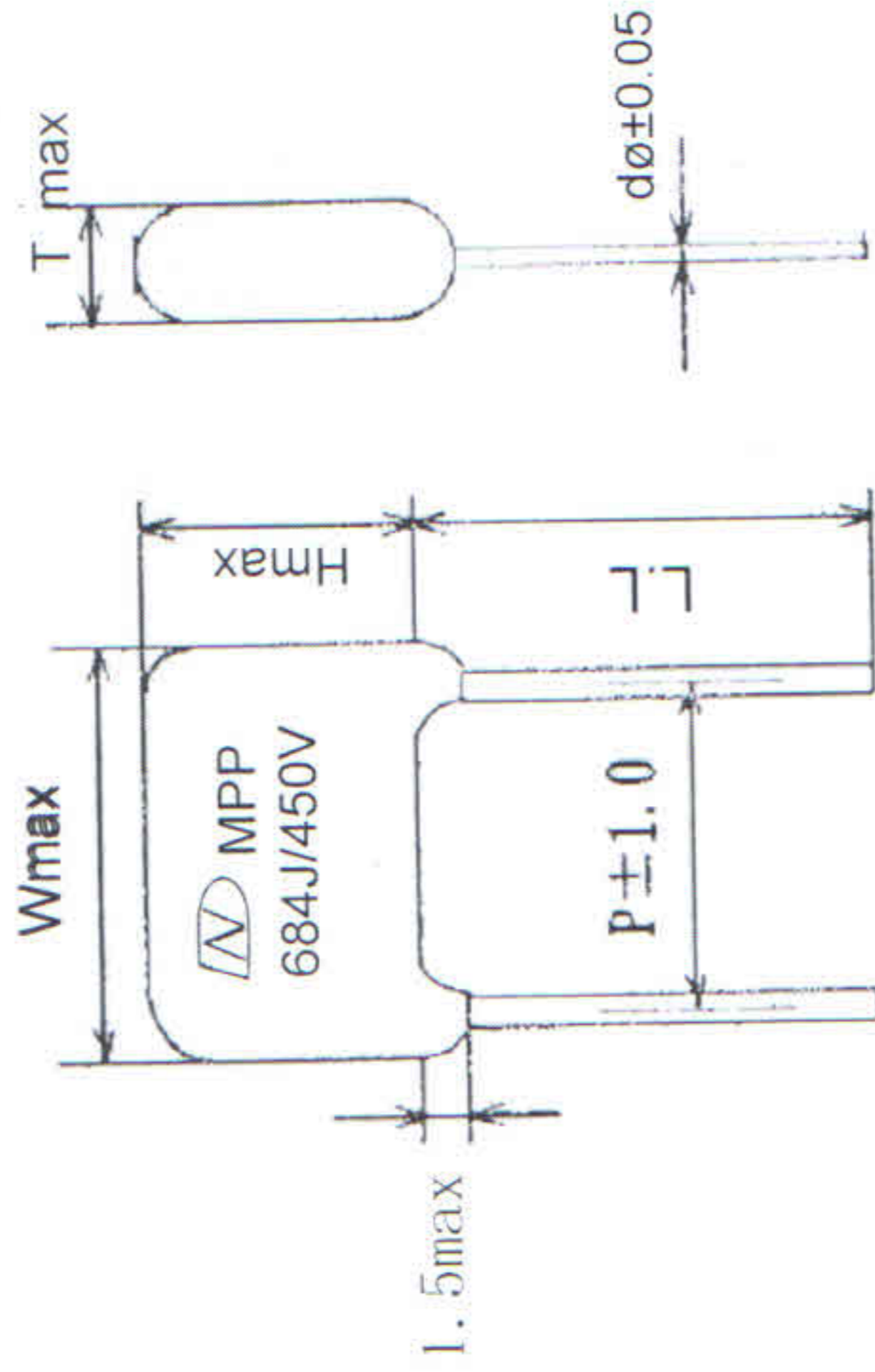

激光印字

Capacitance 容量	@ 1KHZ 23°C±3°C 0.68 µF	Tolerance 误差	±5%	Rated Voltage 额定电压	@ 25°C 50/60HZ 450V
Dielectric 介质	Polypropylene film	Plates 导体	Metallized Aluminum	Construction 结构	Winding
	Dissipation Factor 损失角	@ 1K HZ 1Vrms 25°C max	50~60HZ 1KHZ 10KHZ 150KHZ	0.10% 0.15%	
Test Voltage 测试电压	1.6 times of rated voltage for 5 seconds cut off current at 10mA	DC lead to lead DC lead to case AC lead to lead AC lead to case	Lead to lead Lead to case	720VDCVDCVACVAC	
Dielectric Withstanding Voltage 介质耐压强度	Between terminals 250VACx 200% 1 To 5 sec max		Lead to lead	900VDC	
Insulation Resistance 绝缘阻抗	20°C@ 100 VDC 60 seconds min 20°C@.....VDC..... seconds min		Lead to case	>10000 MΩ*ufMΩ	
dv/dt 单位时间电压变化率	max		Max pulse rise time	(v/sec)	
IpeakA 最大值电流	@70°C			Amps	
IrmsA 实效值电流	@70°C		Amps	
Surge/Pulse voltage 冲击电压	140% rated voltage max			VDC	
E.S.R 等效串联阻抗抗值			Standard 依循标准	IEC384 -2	

Safety approval安规认证	Dimension(尺寸)mm		
	W	H	T
	18.0(MAX)	13(MAX)	8.0(MAX)
	dø	L.L	15±1.0
	0.6±0.05	25.0±3.0	

Remark 备注:	Confirmation area 客户承认签回区	Operating Temperature 工作温度范围 From Minus -40 °C to Plus +105°C	Design code 设计代码: MPP 684J450V P=15
ROHS	B. P. IMPEX PVT LTD. 206, 9/2, EAST PATEL NAGAR, NEW DELHI-110008	DATE 日期: 2015-07-09	Designer 设计师
		3RD ANGLE PROJECTION 第三角法	Drawing 绘图员
	SCALE ~	UNIT mm	Approval 核准
			Drawing NO.